



- For safely running cables into Ex e and Ex i areas
- Can be used in a temperature range from -60 to +75 °C, degree of protection IP68
- Available in Ex e and Ex i versions; the Ex i version is identified by a blue cap nut
- Cable dia. ranges from 1 to 48 mm
- Versions with multi-seal inserts

MY R. STAHL 8161B



R. STAHL's Series 8161/7 and 8161/8 cable glands can be used to safely run cables into Ex e enclosures. They are suitable for cable diameters between 1 and 48 mm. They are available for Ex e and Ex i electrical circuits – the Ex i version can be distinguished by its blue cap nut. A stopping plug for unused entries can be integrated into the entries.

	IECEX / ATEX					
Zone	0	1	2	20	21	22
Installation in		•	•		•	•

Selection Table										
Product Description		Cable gland For low temperature								
Ambient temperature		-60 °C ... +75 °C								
Variant		Low temperature								
Ex version		Ex e								
Thread size	Clamping range	Width across flats	Width across corners	Thread length	Total length	Colour	Lot size	Product Type	Art. No.	Weight
M16	5 – 9 mm	20 mm	22 mm	9 mm	31 to 37 mm	Black	50	8161/7-M16-0905-LT	239203	9 g
M20	7 – 13 mm	24 mm	27 mm	10 mm	36 to 43 mm	Black	50	8161/7-M20-1307-LT	239204	13 g
M25	10 – 17 mm	29 mm	32 mm	10 mm	38 to 46 mm	Black	50	8161/7-M25-1710-LT	239205	19 g
M32	13 – 21 mm	36 mm	40 mm	12 mm	42 to 50 mm	Black	25	8161/7-M32-2113-LT	239206	32 g
M40	17 – 28 mm	46 mm	51 mm	12 mm	52 to 65 mm	Black	10	8161/7-M40-2817-LT	239207	68 g
M50	23 – 35 mm	55 mm	61 mm	14 mm	59 to 72 mm	Black	4	8161/7-M50-3523-LT	239208	107 g
M63	34 – 48 mm	68 mm	75 mm	15 mm	64 to 78 mm	Black	1	8161/7-M63-4834-LT	239209	155 g
Product Description		Cable gland For low temperature								
Ambient temperature		-60 °C ... +75 °C								
Variant		Low temperature								
Ex version		Ex i								
Thread size	Clamping range	Width across flats	Width across corners	Thread length	Total length	Colour	Lot size	Product Type	Art. No.	Weight
M16	5 – 9 mm	20 mm	22 mm	9 mm	31 to 37 mm	Blue	50	8161/8-M16-0905-LT	239211	9 g
M20	7 – 13 mm	24 mm	27 mm	10 mm	36 to 43 mm	Blue	50	8161/8-M20-1307-LT	239212	13 g

Selection Table

Product Description		Cable gland For low temperature -60 °C ... +75 °C								
Ambient temperature		Low temperature								
Variant		Ex i								
Ex version										
Thread size	Clamping range	Width across flats	Width across corners	Thread length	Total length	Colour	Lot size	Product Type	Art. No.	Weight
M25	10 – 17 mm	29 mm	32 mm	10 mm	38 to 46 mm	Blue	50	8161/8-M25-1710-LT	239213	19 g
M32	13 – 21 mm	36 mm	40 mm	12 mm	42 to 50 mm	Blue	25	8161/8-M32-2113-LT	239214	32 g
M40	17 – 28 mm	46 mm	51 mm	12 mm	52 to 65 mm	Blue	10	8161/8-M40-2817-LT	239215	68 g
M50	23 – 35 mm	55 mm	61 mm	14 mm	59 to 72 mm	Blue	4	8161/8-M50-3523-LT	239216	107 g
M63	34 – 48 mm	68 mm	75 mm	15 mm	64 to 78 mm	Blue	1	8161/8-M63-4834-LT	239217	155 g
Product Description		Cable gland with multiple sealing insert Black 4								
Number of cables		-40 °C ... +75 °C								
Ambient temperature		Ex e								
Ex version										
Thread size	Clamping range	Width across flats	Width across corners	Thread length	Total length	Colour	Lot size	Product Type	Art. No.	Weight
M25	3.2 – 3.5 mm	29 mm	32 mm	10 mm	38 to 46 mm	Black	50	8161/7-M25-9999-MFD-04035	265083	20 g
Product Description		Cable gland with multiple sealing insert Black 4								
Number of cables		-40 °C ... +75 °C								
Ambient temperature		Ex i								
Ex version										
Thread size	Clamping range	Width across flats	Width across corners	Thread length	Total length	Colour	Lot size	Product Type	Art. No.	Weight
M25	3.2 – 3.5 mm	29 mm	32 mm	10 mm	38 to 46 mm	Blue	50	8161/8-M25-9999-MFD-04035	265084	20 g
Product Description		Cable gland with multiple sealing insert Green 4								
Number of cables		-40 °C ... +75 °C								
Ambient temperature		Ex e								
Ex version										
Thread size	Clamping range	Width across flats	Width across corners	Thread length	Total length	Colour	Lot size	Product Type	Art. No.	Weight
M25	4.1 – 4.5 mm	29 mm	32 mm	10 mm	38 to 46 mm	Black	50	8161/7-M25-9999-MFD-04045	265085	20 g
Product Description		Cable gland with multiple sealing insert Green 4								
Number of cables		-40 °C ... +75 °C								
Ambient temperature		Ex i								
Ex version										
Thread size	Clamping range	Width across flats	Width across corners	Thread length	Total length	Colour	Lot size	Product Type	Art. No.	Weight
M25	4.1 – 4.5 mm	29 mm	32 mm	10 mm	38 to 46 mm	Blue	50	8161/8-M25-9999-MFD-04045	265086	20 g
Product Description		Cable gland with multiple sealing insert Red 4								
Number of cables		-40 °C ... +75 °C								
Ambient temperature		Ex e								
Ex version										
Thread size	Clamping range	Width across flats	Width across corners	Thread length	Total length	Colour	Lot size	Product Type	Art. No.	Weight
M25	4.7 – 5.2 mm	29 mm	32 mm	10 mm	38 to 46 mm	Black	50	8161/7-M25-9999-MFD-04052	265087	20 g
M32	4.5 – 5 mm	36 mm	40 mm	12 mm	42 to 50 mm	Black	25	8161/7-M32-9999-MFD-04050	265089	36 g

Selection Table										
Product Description Number of cables Ambient temperature Ex version			Cable gland with multiple sealing insert Red 4 -40 °C ... +75 °C Ex i							
Thread size	Clamping range	Width across flats	Width across corners	Thread length	Total length	Colour	Lot size	Product Type	Art. No.	Weight
M25	4.7 – 5.2 mm	29 mm	32 mm	10 mm	38 to 46 mm	Blue	50	8161/8-M25-9999-MFD-04052	265088	20 g
M32	4.5 – 5 mm	36 mm	40 mm	12 mm	42 to 50 mm	Blue	25	8161/8-M32-9999-MFD-04050	265090	36 g
Product Description Number of cables Ambient temperature Ex version			Cable gland with multiple sealing insert White 4 -40 °C ... +75 °C Ex e							
Thread size	Clamping range	Width across flats	Width across corners	Thread length	Total length	Colour	Lot size	Product Type	Art. No.	Weight
M25	3.6 – 4 mm	29 mm	32 mm	10 mm	38 to 46 mm	Black	50	8161/7-M25-9999-MFD-04040	261983	20 g
M25	5.4 – 6 mm	29 mm	32 mm	10 mm	38 to 46 mm	Black	50	8161/7-M25-9999-MFD-04060	261981	20 g
M32	6.3 – 7 mm	36 mm	40 mm	12 mm	42 to 50 mm	Black	25	8161/7-M32-9999-MFD-04070	265091	36 g
Product Description Number of cables Ambient temperature Ex version			Cable gland with multiple sealing insert White 4 -40 °C ... +75 °C Ex i							
Thread size	Clamping range	Width across flats	Width across corners	Thread length	Total length	Colour	Lot size	Product Type	Art. No.	Weight
M25	3.6 – 4 mm	29 mm	32 mm	10 mm	38 to 46 mm	Blue	50	8161/8-M25-9999-MFD-04040	261984	20 g
M25	5.4 – 6 mm	29 mm	32 mm	10 mm	38 to 46 mm	Blue	50	8161/8-M25-9999-MFD-04060	261982	20 g
M32	6.3 – 7 mm	36 mm	40 mm	12 mm	42 to 50 mm	Blue	25	8161/8-M32-9999-MFD-04070	265092	36 g
Product Description Ambient temperature Variant Ex version			Cable gland Without reduction sealing insert -40 °C ... +75 °C Standard thread Ex e							
Thread size	Clamping range	Width across flats	Width across corners	Thread length	Total length	Colour	Lot size	Product Type	Art. No.	Weight
M16	5 – 9 mm	20 mm	22 mm	9 mm	31 to 37 mm	Black	50	8161/7-M16-0905	239171	9 g
M20	7 – 13 mm	24 mm	27 mm	10 mm	36 to 43 mm	Black	50	8161/7-M20-1307	239172	13 g
M25	10 – 17 mm	29 mm	32 mm	10 mm	38 to 46 mm	Black	50	8161/7-M25-1710	239173	19 g
M32	13 – 21 mm	36 mm	40 mm	12 mm	42 to 50 mm	Black	25	8161/7-M32-2113	239174	32 g
M40	17 – 28 mm	46 mm	51 mm	12 mm	52 to 65 mm	Black	10	8161/7-M40-2817	239175	68 g
M50	23 – 35 mm	55 mm	61 mm	14 mm	59 to 72 mm	Black	4	8161/7-M50-3523	239176	107 g
M63	34 – 48 mm	68 mm	75 mm	15 mm	64 to 78 mm	Black	1	8161/7-M63-4834	239177	155 g

Selection Table

Product Description		Cable gland Without reduction sealing insert								
Ambient temperature		-40 °C ... +75 °C								
Variant		Standard thread								
Ex version		Ex i								
Thread size	Clamping range	Width across flats	Width across corners	Thread length	Total length	Colour	Lot size	Product Type	Art. No.	Weight
M16	5 – 9 mm	20 mm	22 mm	9 mm	31 to 37 mm	Blue	50	8161/8-M16-0905	239179	9 g
M20	7 – 13 mm	24 mm	27 mm	10 mm	36 to 43 mm	Blue	50	8161/8-M20-1307	239180	13 g
M25	10 – 17 mm	29 mm	32 mm	10 mm	38 to 46 mm	Blue	50	8161/8-M25-1710	239181	19 g
M32	13 – 21 mm	36 mm	40 mm	12 mm	42 to 50 mm	Blue	25	8161/8-M32-2113	239182	32 g
M40	17 – 28 mm	46 mm	51 mm	12 mm	52 to 65 mm	Blue	10	8161/8-M40-2817	239183	68 g
M50	23 – 35 mm	55 mm	61 mm	14 mm	59 to 72 mm	Blue	4	8161/8-M50-3523	239184	107 g
M63	34 – 48 mm	68 mm	75 mm	15 mm	64 to 78 mm	Blue	1	8161/8-M63-4834	239185	155 g
Product Description		Cable gland Without reduction sealing insert								
Ambient temperature		15 °C ... +65 °C								
Variant		Standard thread								
Ex version		Ex e								
Thread size	Clamping range	Width across flats	Width across corners	Thread length	Total length	Colour	Lot size	Product Type	Art. No.	Weight
M12	3 – 6 mm	16 mm	18 mm	9 mm	29 to 34 mm	Black	50	8161/7-M12-0603	239170	7 g
Product Description		Cable gland Without reduction sealing insert								
Ambient temperature		15 °C ... +65 °C								
Variant		Standard thread								
Ex version		Ex i								
Thread size	Clamping range	Width across flats	Width across corners	Thread length	Total length	Colour	Lot size	Product Type	Art. No.	Weight
M12	3 – 6 mm	16 mm	18 mm	9 mm	29 to 34 mm	Blue	50	8161/8-M12-0603	239178	7 g
Product Description		Cable gland With reduction sealing insert								
Ambient temperature		-40 °C ... +75 °C								
Variant		Long thread								
Ex version		Ex e								
Thread size	Clamping range	Width across flats	Width across corners	Thread length	Total length	Colour	Lot size	Product Type	Art. No.	Weight
M16	2 – 9 mm	20 mm	22 mm	15 mm	37 to 43 mm	Black	50	8161/7-M16-0902-L	239187	9 g
M20	4 – 13 mm	24 mm	27 mm	15 mm	41 to 48 mm	Black	50	8161/7-M20-1304-L	239188	13 g
M25	7 – 17 mm	29 mm	32 mm	15 mm	43 to 51 mm	Black	50	8161/7-M25-1707-L	239189	19 g
M32	9 – 21 mm	36 mm	40 mm	15 mm	45 to 53 mm	Black	25	8161/7-M32-2109-L	239190	32 g
M40	12 – 28 mm	46 mm	51 mm	18 mm	58 to 71 mm	Black	10	8161/7-M40-2812-L	239191	68 g
M50	16 – 35 mm	55 mm	61 mm	18 mm	63 to 76 mm	Black	4	8161/7-M50-3516-L	239192	107 g
M63	28 – 48 mm	68 mm	75 mm	18 mm	67 to 81 mm	Black	1	8161/7-M63-4828-L	239193	155 g

Selection Table										
Product Description Ambient temperature Variant Ex version			Cable gland With reduction sealing insert -40 °C ... +75 °C Long thread Ex i							
Thread size	Clamping range	Width across flats	Width across corners	Thread length	Total length	Colour	Lot size	Product Type	Art. No.	Weight
M16	2 – 9 mm	20 mm	22 mm	15 mm	37 to 43 mm	Blue	50	8161/8-M16-0902-L	239195	9 g
M20	4 – 13 mm	24 mm	27 mm	15 mm	41 to 48 mm	Blue	50	8161/8-M20-1304-L	239196	13 g
M25	7 – 17 mm	29 mm	32 mm	15 mm	43 to 51 mm	Blue	50	8161/8-M25-1707-L	239197	19 g
M32	9 – 21 mm	36 mm	40 mm	15 mm	45 to 53 mm	Blue	25	8161/8-M32-2109-L	239198	32 g
M40	12 – 28 mm	46 mm	51 mm	18 mm	58 to 71 mm	Blue	10	8161/8-M40-2812-L	239199	68 g
M63	28 – 48 mm	68 mm	75 mm	18 mm	67 to 81 mm	Blue	1	8161/8-M63-4828-L	239201	155 g
Product Description Ambient temperature Variant Ex version			Cable gland With reduction sealing insert -40 °C ... +75 °C Standard thread Ex e							
Thread size	Clamping range	Width across flats	Width across corners	Thread length	Total length	Colour	Lot size	Product Type	Art. No.	Weight
M16	2 – 9 mm	20 mm	22 mm	9 mm	31 to 37 mm	Black	50	8161/7-M16-0902	239155	9 g
M20	4 – 13 mm	24 mm	27 mm	10 mm	36 to 43 mm	Black	50	8161/7-M20-1304	239156	13 g
M25	7 – 17 mm	29 mm	32 mm	10 mm	38 to 46 mm	Black	50	8161/7-M25-1707	239157	19 g
M32	9 – 21 mm	36 mm	40 mm	12 mm	42 to 50 mm	Black	25	8161/7-M32-2109	239158	32 g
M40	12 – 28 mm	46 mm	51 mm	12 mm	52 to 65 mm	Black	10	8161/7-M40-2812	239159	68 g
M50	16 – 35 mm	55 mm	61 mm	14 mm	59 to 72 mm	Black	4	8161/7-M50-3516	239160	107 g
M63	28 – 48 mm	68 mm	75 mm	15 mm	64 to 78 mm	Black	1	8161/7-M63-4828	239161	155 g
Product Description Ambient temperature Variant Ex version			Cable gland With reduction sealing insert -40 °C ... +75 °C Standard thread Ex i							
Thread size	Clamping range	Width across flats	Width across corners	Thread length	Total length	Colour	Lot size	Product Type	Art. No.	Weight
M16	2 – 9 mm	20 mm	22 mm	9 mm	31 to 37 mm	Blue	50	8161/8-M16-0902	239163	9 g
M20	4 – 13 mm	24 mm	27 mm	10 mm	36 to 43 mm	Blue	50	8161/8-M20-1304	239164	13 g
M25	7 – 17 mm	29 mm	32 mm	10 mm	38 to 46 mm	Blue	50	8161/8-M25-1707	239165	19 g
M32	9 – 21 mm	36 mm	40 mm	12 mm	42 to 50 mm	Blue	25	8161/8-M32-2109	239166	32 g
M40	12 – 28 mm	46 mm	51 mm	12 mm	52 to 65 mm	Blue	10	8161/8-M40-2812	239167	68 g
M50	16 – 35 mm	55 mm	61 mm	14 mm	59 to 72 mm	Blue	4	8161/8-M50-3516	239168	107 g
M63	28 – 48 mm	68 mm	75 mm	15 mm	64 to 78 mm	Blue	1	8161/8-M63-4828	239169	155 g

Selection Table

Product Description		Cable gland With reduction sealing insert								
Ambient temperature		15 °C ... +65 °C								
Variant		Long thread								
Ex version		Ex e								
Thread size	Clamping range	Width across flats	Width across corners	Thread length	Total length	Colour	Lot size	Product Type	Art. No.	Weight
M12	1 – 6 mm	16 mm	18 mm	15 mm	35 to 40 mm	Black	50	8161/7-M12-0601-L	239186	7 g
Product Description		Cable gland With reduction sealing insert								
Ambient temperature		15 °C ... +65 °C								
Variant		Long thread								
Ex version		Ex i								
Thread size	Clamping range	Width across flats	Width across corners	Thread length	Total length	Colour	Lot size	Product Type	Art. No.	Weight
M12	1 – 6 mm	16 mm	18 mm	15 mm	35 to 40 mm	Blue	50	8161/8-M12-0601-L	239194	7 g
Product Description		Cable gland With reduction sealing insert								
Ambient temperature		15 °C ... +65 °C								
Variant		Standard thread								
Ex version		Ex e								
Thread size	Clamping range	Width across flats	Width across corners	Thread length	Total length	Colour	Lot size	Product Type	Art. No.	Weight
M12	1 – 6 mm	16 mm	18 mm	9 mm	29 to 34 mm	Black	50	8161/7-M12-0601	239154	7 g
Product Description		Cable gland With reduction sealing insert								
Ambient temperature		15 °C ... +65 °C								
Variant		Standard thread								
Ex version		Ex i								
Thread size	Clamping range	Width across flats	Width across corners	Thread length	Total length	Colour	Lot size	Product Type	Art. No.	Weight
M12	1 – 6 mm	16 mm	18 mm	9 mm	29 to 34 mm	Blue	50	8161/8-M12-0601	239162	7 g

Lot size: Purchase order quantity in [no. of units]; the delivery quantity is automatically rounded to the lot size.

Technical Data

Variant	8161/-M.-.....	8161/-M.-.....-LT
Explosion Protection		
IECEX gas explosion protection	Ex eb IIC Gb	Ex eb IIC Gb
IECEX dust explosion protection	Ex tb IIIC Db	Ex tb IIIC Db
ATEX gas explosion protection	Ⓜ II 2 G Ex eb IIC Gb	Ⓜ II 2 G Ex eb IIC Gb
ATEX dust explosion protection	Ⓜ II 2 D Ex tb IIIC Db	Ⓜ II 2 D Ex tb IIIC Db
Certificates	ATEX (PTB), Brazil (ULB), IECEX (PTB), Korea (KGS)	
Declaration of Conformity	ATEX (EUK)	
Mechanical Data		
Material	Polyamide	Polyamide
Material	Polyamide, Glass fibre reinforced	Polyamide, Glass fibre reinforced
Degree of protection (IP)	IP66	IP66
Degree of protection note	IP68 at 5 bar 30 min. (IP protection according to IEC/EN 60529)	
Sealing material	EPDM profile seal	SI profile seal
Silicone-free	Yes	No
Self-extinguishing	Yes	Yes
Flame-retardant	Yes	Yes
Halogen-free	Yes	Yes
Surface resistance	≤10 ¹³ Ω	≤10 ¹³ Ω

Accessories				
Figure	Description		Art. No.	Weight
Jam nut, nickel-plated brass				
	Material: Nickel-plated brass Thread size: M12	Lot size: 100	241518	220 g
	Material: Nickel-plated brass Thread size: M16	Lot size: 100	241519	290 g
	Material: Nickel-plated brass Thread size: M20	Lot size: 100	241520	480 g
	Material: Nickel-plated brass Thread size: M25	Lot size: 100	241561	720 g
	Material: Nickel-plated brass Thread size: M32	Lot size: 50	241562	545 g
	Material: Nickel-plated brass Thread size: M40	Lot size: 50	241563	1.03 kg
	Material: Nickel-plated brass Thread size: M50	Lot size: 25	241564	680 g
	Material: Nickel-plated brass Thread size: M63	Lot size: 10	241565	499 g
Jam nut, plastic (-40 to +75 °C) For mounting the cable entries in through holes				
	Material: Polyamide Thread size: M12	Lot size: 100	239460	1 g
	Material: Polyamide Thread size: M16	Lot size: 100	239461	2 g
	Material: Polyamide Thread size: M20	Lot size: 100	239462	2 g
	Material: Polyamide Thread size: M25	Lot size: 100	239463	3 g
	Material: Polyamide Thread size: M40	Lot size: 50	239465	7 g
	Material: Polyamide Thread size: M50	Lot size: 25	239466	12 g
	Material: Polyamide Thread size: M63	Lot size: 10	239467	18 g
Reduction sealing insert (standard), EPDM (-40 to +75 °C) For cable glands				
	Connection thread: M16 x 1.5 Clamping range: 2 to 6 mm	Batch size: 50	239445	1 g
	Connection thread: M20 x 1.5 Clamping range: 4 to 8 mm	Batch size: 50	239446	1 g
	Connection thread: M25 x 1.5 Clamping range: 7 to 12 mm	Batch size: 25	239447	3 g
	Connection thread: M32 x 1.5 Clamping range: 9 to 14 mm	Batch size: 25	239448	3 g
	Connection thread: M40 x 1.5 Clamping range: 12 to 20 mm	Batch size: 10	239449	7 g
Reduction sealing insert, silicone (-60 to +75 °C) For low temperatures				
	Connection thread: M16 x 1.5 Cable dia. range: 2 to 6 mm	Lot size: 50	239453	1 g
	Connection thread: M20 x 1.5 Cable dia. range: 4 to 8 mm	Lot size: 50	239454	1 g
	Connection thread: M25 x 1.5 Cable dia. range: 7 to 12 mm	Lot size: 25	239455	2 g
	Connection thread: M32 x 1.5 Cable dia. range: 9 to 14 mm	Lot size: 25	239456	3 g
	Connection thread: M40 x 1.5 Cable dia. range: 12 to 20 mm	Lot size: 10	239457	8 g
	Connection thread: M50 x 1.5 Cable dia. range: 16 to 25 mm	Lot size: 10	239458	15 g

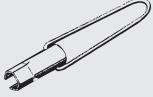
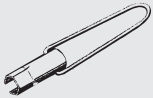
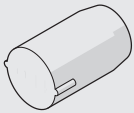
Accessories				
Figure	Description		Art. No.	Weight
Special key				
	Thread size: M20	Packaging unit: 1	114208	132 g
	Thread size: M25	Packaging unit: 1	114205	163 g
Special key For tightening cable glands and cap nuts				
	Thread size: M16	Packaging unit: 1	114207	120 g
	Thread size: M32	Packaging unit: 1	114209	237 g
	Thread size: M40	Packaging unit: 1	114210	274 g
Plug (-60 to +75 °C; depending on the cable gland used) For sealing unused cable glands Material: Polyamide				
	Diameter: 3 mm	Lot size: 50	240044	1 g
	Diameter: 6 mm	Lot size: 50	240046	1 g
	Diameter: 8 mm	Lot size: 50	240048	1 g
	Diameter: 12 mm	Lot size: 50	240049	2 g
	Diameter: 17 mm	Lot size: 50	240056	3 g
	Diameter: 14 mm	Lot size: 50	240050	3 g
	Diameter: 20 mm	Lot size: 25	240057	4 g
	Diameter: 28 mm	Lot size: 25	240059	9 g
	Diameter: 25 mm	Lot size: 25	240058	7 g
	Diameter: 35 mm	Lot size: 10	240060	10 g
	Diameter: 48 mm	Lot size: 10	240062	28 g

Spare Parts

Figure	Description	Art. No.	Weight
Flat seal (standard), EPDM (-40 to +75 °C) Replacement seals for cable glands			
	For cable glands 8161/-M12-06... Connection thread: M12 x 1.5	Lot size: 100	240245 1 g
	For cable glands 8161/-M12-06.. Connection thread: M12 x 1.5	Lot size: 50	240244 1 g
	For cable glands 8161/-M16-09.. Connection thread: M16	Lot size: 100	222370 1 g
	For cable glands 8161/-M16-09... Connection thread: M16	Lot size: 50	222363 1 g
	For cable glands 8161/-M20-13 Connection thread: M20	Lot size: 100	222371 1 g
	For cable glands 8161/-M20-13 Connection thread: M20	Lot size: 50	222364 1 g
	For cable glands 8161/-M25-17 Connection thread: M25	Lot size: 100	222372 1 g
	For cable glands 8161/-M25-17 Connection thread: M25	Lot size: 50	222365 1 g
	For cable glands 8161/-M32-21 Connection thread: M32	Lot size: 100	222373 1 g
	For cable glands 8161/-M32-21 Connection thread: M32	Lot size: 50	222366 1 g
	For cable glands 8161/-M40-28 Connection thread: M40	Lot size: 100	222374 2 g
	For cable glands 8161/-M40-28 Connection thread: M40	Lot size: 50	222367 2 g
	For cable glands 8161/-M50-35 Connection thread: M50	Lot size: 100	222375 2 g
	For cable glands 8161/-M50-35 Connection thread: M50	Lot size: 50	222368 2 g
	For cable glands 8161/-M63-48 Connection thread: M63	Lot size: 100	222376 2 g
For cable glands 8161/-M63-48 Connection thread: M63	Lot size: 50	222369 2 g	
Silicone flat seal (-60 to +75 °C) Replacement seals for low temperatures			
	For cable glands 8161/-M16-09.. Connection thread: M16	Lot size: 100	240248 1 g
	For cable glands 8161/-M20-13 Connection thread: M20	Lot size: 100	240249 1 g
	For cable glands 8161/-M25-17 Connection thread: M25	Lot size: 100	240250 1 g
	For cable glands 8161/-M32-21 Connection thread: M32	Lot size: 100	240251 1 g
	For cable glands 8161/-M40-28 Connection thread: M40	Lot size: 100	240252 2 g
	For cable glands 8161/-M50-35 Connection thread: M50	Lot size: 100	240253 2 g
	For cable glands 8161/-M63-48 Connection thread: M63	Lot size: 100	240254 2 g

Lot size: Purchase order quantity in [no. of units]; the delivery quantity is automatically rounded to the lot size.

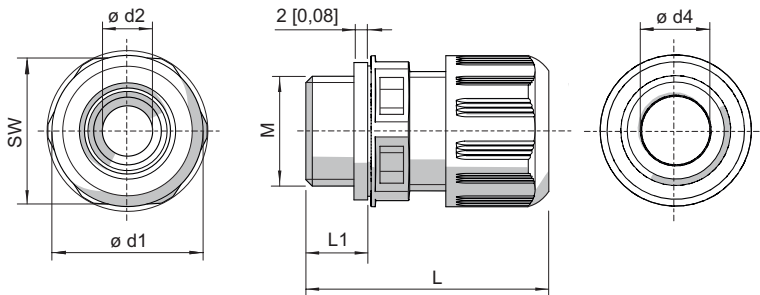

M = Thread size SW = Width across flats
 L1 = Thread length L = Total length

Cable glands without bend protection

Thread size	Width across flats	Total length	Total length (with long thread)	Thread length	Thread length (long thread)	Clamping range	Clamping range + reduction sealing insert	Dimension d1	Dimension d2	Dimension d4
M12	16.00 mm	29 to 34 mm	35 to 40 mm	9 mm	15 mm	3 - 6 mm	1 - 6 mm	18 mm	7.3 mm	6.3 mm
M16	20.00 mm	31 to 37 mm	37 to 43 mm	9 mm	15 mm	5 - 9 mm	2 - 9 mm	22 mm	10.3 mm	9.3 mm
M20	24.00 mm	36 to 43 mm	41 to 48 mm	10 mm	15 mm	7 - 13 mm	4 - 13 mm	27 mm	13.3 mm	13.3 mm
M25	29.00 mm	38 to 46 mm	43 to 51 mm	10 mm	15 mm	10 - 17 mm	7 - 17 mm	32 mm	17.3 mm	17.3 mm
M32	36.00 mm	42 to 50 mm	45 to 53 mm	12 mm	15 mm	13 - 21 mm	9 - 21 mm	40 mm	21.3 mm	21.3 mm
M40	46.00 mm	52 to 65 mm	58 to 71 mm	12 mm	18 mm	17 - 28 mm	12 - 28 mm	51 mm	28.3 mm	30 mm
M50	55.00 mm	59 to 72 mm	63 to 76 mm	14 mm	18 mm	23 - 35 mm	16 - 35 mm	61 mm	35.3 mm	40 mm
M63	68.00 mm	64 to 78 mm	67 to 81 mm	15 mm	18 mm	34 - 48 mm	28 - 48 mm	75 mm	48.3 mm	53 mm