



## Herkules 2

Microwave motion detector  
for industrial doors

### Reliable, robust, universal

- **Rapid reaction time, ideal for high-speed doors**
- **Versatile applications for heights from 2 to 7 m and temperatures from -30 °C to +60 °C**
- **Practical default settings for a variety of industrial door applications**
- **Broad selection of evaluation options for people and vehicles**
- **Direction recognition and crossing traffic masking**



# Herkules 2

## Microwave motion detector for industrial doors

### Universally applicable

The Herkules 2 microwave motion detector has been specifically developed for use with industrial doors. It detects, differentiates between or masks out people or vehicles and can switch the output relays separately, depending on the requirement.

### First class, tried-and-tested

Herkules 2 is a logical further refinement of our successful microwave detectors that are also used for automatic doors. Our long experience, combined with progressive planar technology, gives Herkules 2 a considerable range of functions and reliability.



## Your benefits

### Prevents unwanted opening

- Crossing traffic masking

### Inexpensive and simple logistics

- One device for many applications

### Wide range of applications for almost all heights of industrial doors

- Detection height from 2 to 7 metres

### Intelligent control of the industrial door

- Differentiation between or masking of people and vehicles

### Rapid startup

- Default enhanced function settings, straightforward wall or ceiling mounting

### Straightforward configuration and initialisation

- Setting using programming switches or RegloBeam 2 remote control

### Can be set to function with different industrial door controllers

- The fall-delay time of the outputs can be varied between 5 levels

### Variable detection areas for any application

- Nine possible field sizes can be set

### Industrial aluminium housing

- Particularly robust aluminium housing

## Preprogrammed default settings

Easy to select options for evaluating people and/or vehicles

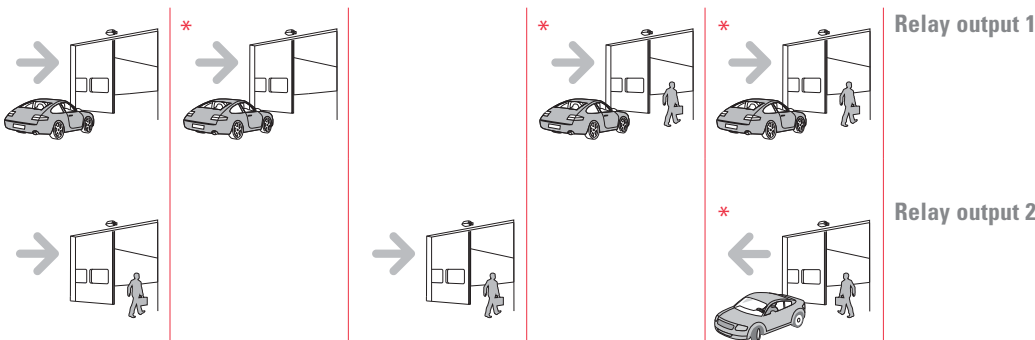

\* Also as default setting for high-speed doors



## Extended accessories

The RegloBeam 2 bidirectional remote control allows the Herkules 2 to be configured quickly and completely from ground level, and every single parameter can be adapted to the particular situation. The RegloBeam 2 is also used with many of our other detectors.



RegloBeam 2 remote control



## Reliable in every application

### Situation

Activation of sectional gates

### Solution

- Optimum traffic flow thanks to reliable activation of the industrial door controller

### Advantages

- Direction recognition means the industrial door only remains open for as long as necessary
- Crossing traffic masking to prevent unintentional opening of the industrial door

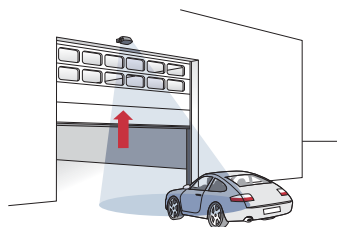

### Situation

Use on roller gate or high-speed door in logistics areas

### Solution

- Early-stage opening simply by selecting one of nine possible field sizes (see back page) and rapid detection of people/vehicles

### Advantages

- Optimum goods flow thanks to early-stage detection and immediate opening
- Even low and wide industrial doors profit from the flexible settings for ideal activation

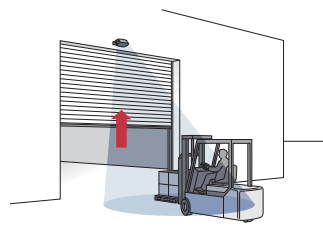

### Situation

Activation of sliding gates for people and vehicles

### Solution

- Detection of people/vehicles with separate outputs for intelligent activation

### Advantages

- Saves energy in the hall because the industrial door does not open completely when pedestrians are detected

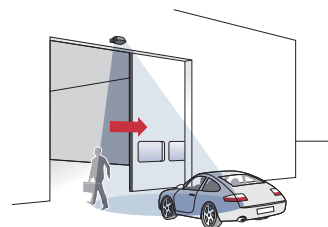

### Situation

Delivery at folding door with truck

### Solution

- Also ideal for use on wide and tall industrial doors

### Advantages

- Reliable detection due to flexible adjustments to the microwave field
- No need for the driver to get out
- Optimum traffic flow

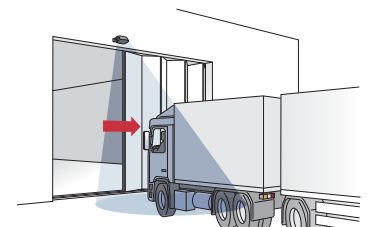

## Maximum field dimensions

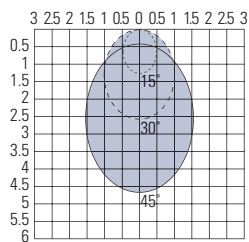

**2.5 m mounting height**  
Setting angle 15°–45°

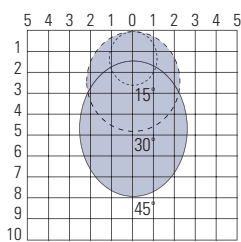

**4.5 m mounting height**  
Setting angle 15°–45°

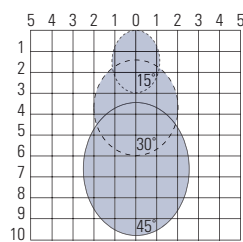

**7 m mounting height**  
Setting angle 15°–45°

## Order details

Article no.	Description
<b>223152</b>	<b>Herkules 2</b> Microwave motion detector for industrial doors



Accessories	
<b>357649</b>	<b>Herkules 2</b> Holder complete



<b>292393</b>	<b>RegloBeam 2</b> Bidirectional remote control
---------------	--



## Supplementary products

<b>ClickLine</b>	Electrical safety edge Rubber profiles with click-fit foot
------------------	---



<b>CoverLine</b>	Electrical safety edge Rubber profiles for clicking in at the side
------------------	---



## Technical data

Mechanical data	
<b>Mounting height</b>	2.0 to 7.0 m
<b>Connection type</b>	cable 5 m, 8 x 0.14 mm <sup>2</sup>
<b>Housing material</b>	black anodised aluminium, polycarbonate cover
<b>Dimensions</b>	134 x 82 x 75 mm
<b>Weight</b>	720 g incl. cable

Technology data	
<b>Technology</b>	Doppler radar with planar module
<b>Transmitting frequency</b>	24.05–24.25 GHz
<b>Transmitting power</b>	< 20 dBm
<b>Mains frequency</b>	50 Hz
<b>Max. detection speed</b>	25 km/h for vehicles

Electrical data	
<b>Operating voltage</b>	12–28 V AC, 12–36 V DC
<b>Operating current</b>	max. 75 mA
<b>Relay outputs</b>	potential-free changeover contacts
<b>Switching voltage</b>	max. 48 V AC/DC
<b>Switching current</b>	max. 0.5 A AC

Ambient conditions	
<b>Protection class (EN 60529)</b>	IP 65
<b>Temperature range</b>	–30 °C to +60 °C
<b>Air humidity</b>	0% to 95% relative, without condensation

Standards	
<b>Approvals</b>	CE 0682 I / FCC / IC
<b>Suitable for the following countries</b>	EU, EFTA, US, CA

### Note

Technical details and recommendations on our products are based upon experience and represent guidelines for the user. Details in brochures and specification sheets do not guarantee any special product features, apart from those which we confirm in individual cases. We reserve the right to make changes as the result of technical developments.

### BBC Bircher Smart Access

Wiesengasse 20  
8222 Beringen  
Switzerland  
Phone +41 52 687 11 11  
info@bircher.com  
www.bircher.com