

Comfort series
2 mm embeddable

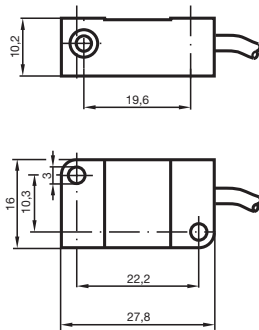

Switching element function	NAMUR NC
Rated operating distance s_n	2 mm
Installation	embeddable
Assured operating distance s_a	0 ... 1,62 mm
Reduction factor r_{AI}	0,25
Reduction factor r_{Cu}	0,2
Reduction factor r_{V2A}	0,7
Nominal voltage U_o	8 V
Switching frequency f	0 ... 1000 Hz
Hysteresis H	typ. %
Current consumption	
Measuring plate not detected	≥ 3 mA
Measuring plate detected	≤ 1 mA
EMC in accordance with	EN 60947-5-2
Standards	DIN EN 60947-5-6 (NAMUR)
Ambient temperature	-25 ... 100 °C (248 ... 373 K)
Connection type	0.1 m, PVC cable
Core cross-section	0.14 mm ²
Housing material	PBT
Sensing face	PBT
Protection degree	IP67

Connection_type:

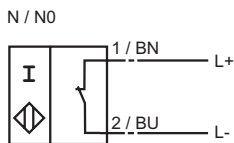

017905_ENG.xml

2003-03-24

www.pepperl-fuchs.com

PEPPERL+FUCHS GmbH

Data for Ex areas

Effective internal inductivity C_i	$\leq 40 \text{ nF}$
Effective internal inductance L_i	$\leq 35 \text{ }\mu\text{H}$